

Assembly instruction

## RibClamp KL System



# Content

▸ Tools overview	3
▸ General safety information	4
▸ The following guidelines apply	5
▸ Required Materials	6
▸ Assembly Landscape	8
▸ Assembly Portrait	11
▸ Notes	15

## QUALITY TESTED – SEVERAL CERTIFICATIONS

K2 Systems stands for secure connections, highest quality and precision. Our customers and business partners have known that for a long time. Independent institutes have tested, confirmed and certified our capabilities and components.

Please find our quality and product certificates under:

[www.k2-systems.com/en/technical-information](http://www.k2-systems.com/en/technical-information)



# Tools overview

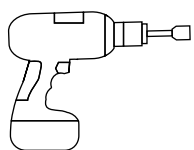

6mm



15mm



6-30Nm  
(4,5-22,2lb-ft)



6mm



15mm

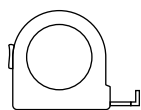

≥3,0m



≥6,0m

# General safety information

Please note that our general mounting instructions must be followed at all times and can be viewed online at [www.k2-systems.com/en/technical-information](http://www.k2-systems.com/en/technical-information)

- The equipment may only be installed and operated by qualified and adequately trained installers.
- Prior to installation, ensure that the product complies with on-site static loading requirements. For roof-mounted systems, the roof load-bearing capacity must always be checked.
- National and local building regulations and environmental requirements must be adhered to.
- Compliance with health and safety regulations, accident prevention guidelines and applicable standards is required.
  - Protective equipment such as safety helmet, boots and gloves must be worn.
  - Roofing works must be in accordance with roofing regulations utilising fall protection safeguards when eaves height exceeds 3 m.
  - At least two people must be present for the duration of the installation work in order to provide rapid assistance in the event of an emergency.
- K2 mounting systems are continuously developed and improved and the installation process may thereby change at any time. Prior to installation consult our website at [www.k2-systems.com/en/technical-information](http://www.k2-systems.com/en/technical-information) for up-to-date instructions. We can send you the latest version on request.
- The assembly instructions of the module manufacturer must be adhered to.
- Equipotential bonding/grounding/earthing between individual parts is to be performed according to country specific standards, as well as national laws and regulations.
- At least one copy of the assembly instructions should be available on site throughout the duration of the installation.
- Failure to adhere to our general safety and assembly instructions and not using all system components, K2 is not liable for any resulting defects or damages. We do not accept liability for any damage resulting in the use of competitor's parts. Warranty is excluded in such cases.
- German law shall apply excluding the UN Convention on CISG. Place of venue is Stuttgart. Our General Terms of Business apply.
- If all safety instructions are adhered to and the system is correctly installed, there is a product warranty entitlement of 12 years! We strongly recommend reviewing our terms of guarantee, which can be viewed at [www.k2-systems.com/en/technical-information](http://www.k2-systems.com/en/technical-information)  
We will also send this information on request.
- Dismantling of the system is performed in reverse order to the assembly.
- K2 stainless steel components are available in different corrosion resistance classes. Each structure or component must be carefully checked for possible corrosion exposure.

# The following guidelines apply

The RibClamp KL system can be installed as standard if the following conditions are met. Even if the system is able to cope with higher requirements due to the inclusion of safety factors, please contact your contact person at K2 Systems for testing if the specified values are exceeded.



## Roof requirements

- Approved for the following roof types:
  - Lysaght: KlipLok 406, KlipLok 700 classic
  - Global Roofing Solution: Klip Tite 700
- Roof pitch: up to 20°



## Static requirements

- The sufficient holding force of the roof covering at the support or substructure must be ensured on site.



## Important mounting instructions

- On-site general standards and regulations for lightning protection must be observed and consultation with a specialist to create a lightning protection concept is recommended (use lightning protection clamp if necessary).
- Minimum spacing of 50 mm between rail end and module frame. We recommend a thermal separation after maximum of 6,1 m.
- MiniClamps and standard module clamps for modules with a frame height of 30-50 mm. Universal clamps for modules with a frame height of 32-42 mm.
- Use MiniClamps for landscape mounting without module mounting rail. Use the standard clamps or universal clamps for portrait mounting with module mounting rail.
- Follow the manufacturer's instructions for the clamping area of the module clamps and for mounting the modules (see module data sheet of the manufacturer) - Tighten with M8 screw and 14 Nm.

# Required Materials

Landscape assembly

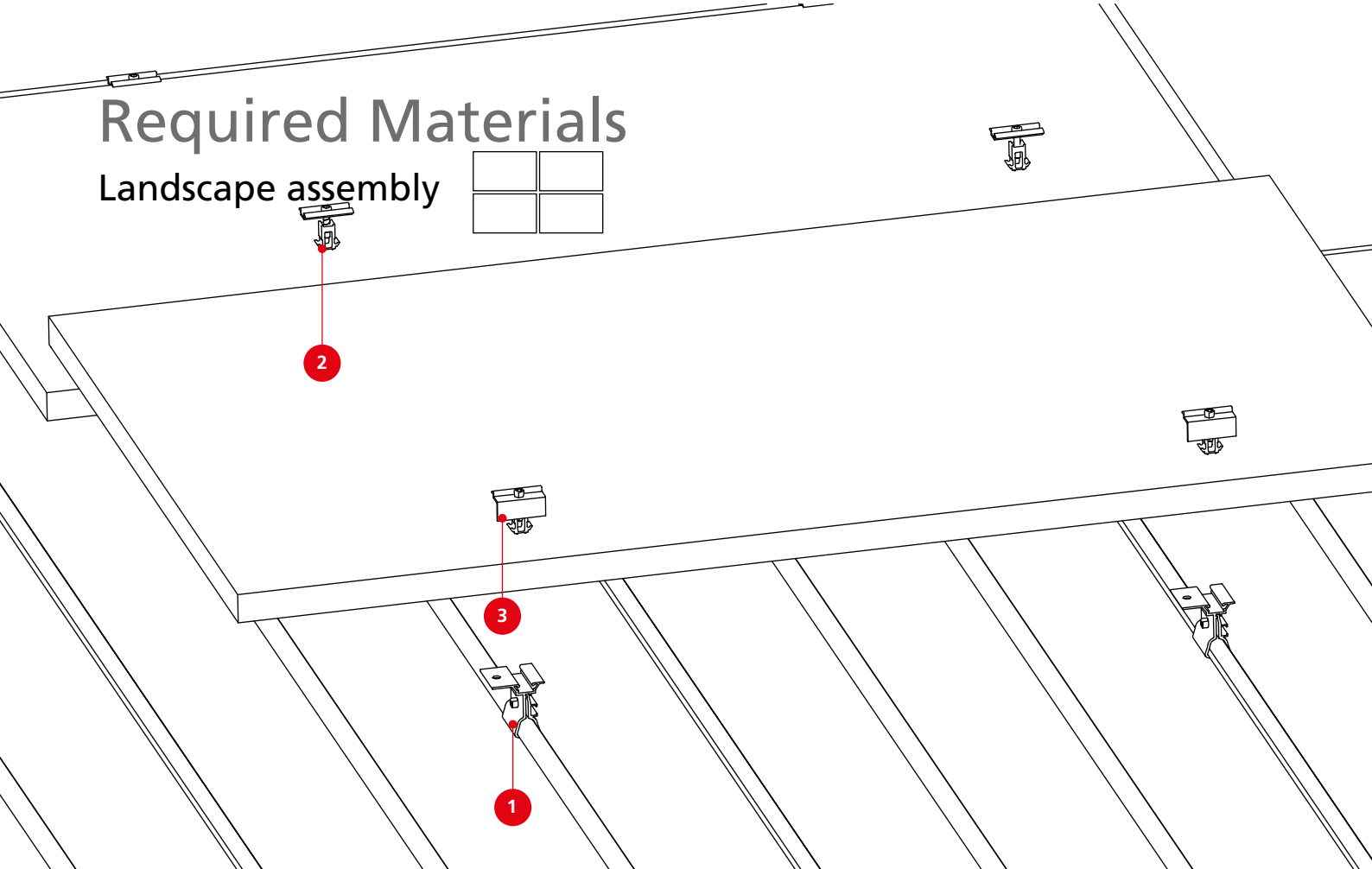

**1** 2002857  
RibClamp KL

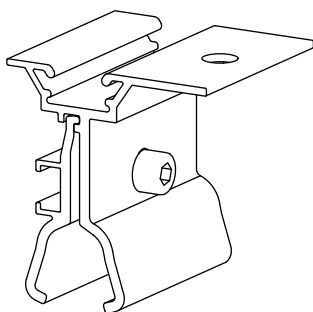

**2** 2002558/2002609  
MiniClamp MC 30-50 mm  
aluminium mill finish /  
black anodised

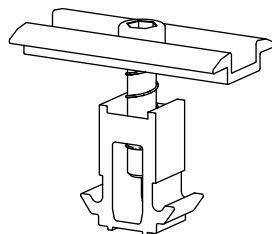

**3** 2002559/2002610  
MiniClamp EC 30-50 mm  
aluminium mill finish /  
black anodised

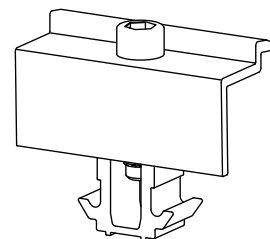

## Portrait assembly

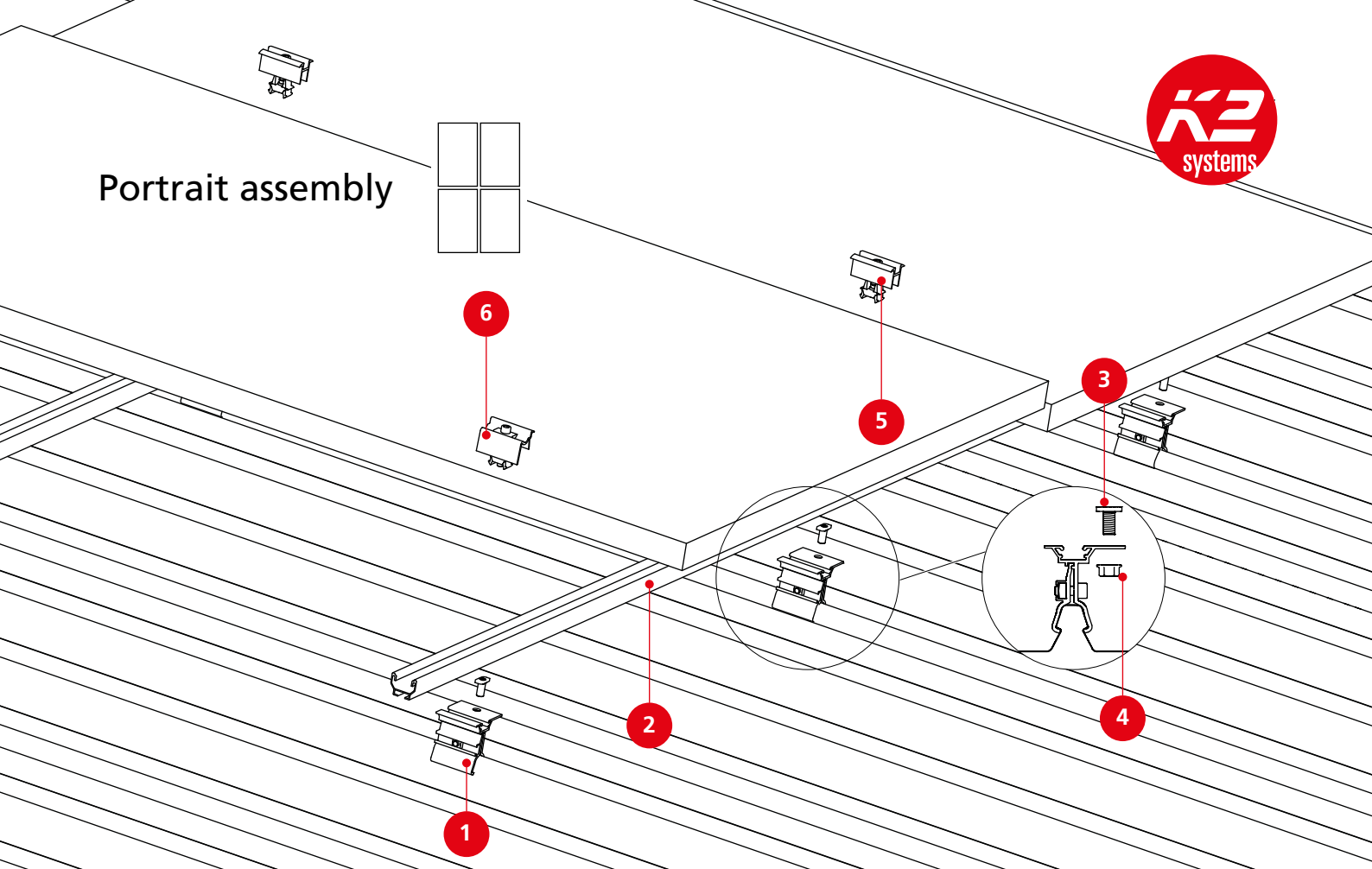

- 1** 2002857  
RibClamp KL

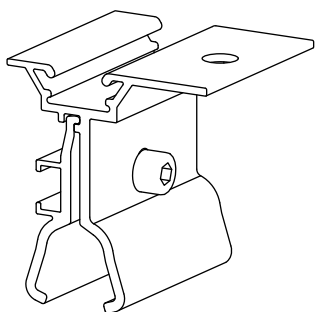

- 2** 2003043  
K2 SolidRail XS 3.25 m

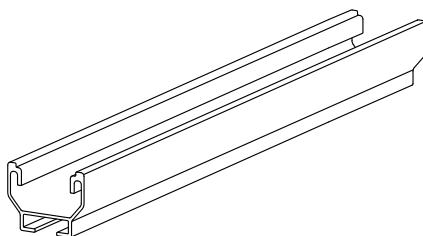

- 3** 2000041  
T-Bolt M10x30  
For fixing the mounting rail



- 4** 2000042  
Nut M10  
For fixing the mounting rail



- 5** 2002514 / 2002589  
Universal clamp OneEnd / Module end clamp  
aluminium mill finish / black anodised

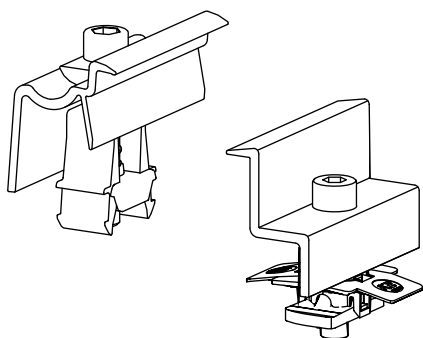

- 6** 2002515 / 2002588  
Universal clamp OneMid / XS Middle clamp  
aluminium mill finish / black anodised

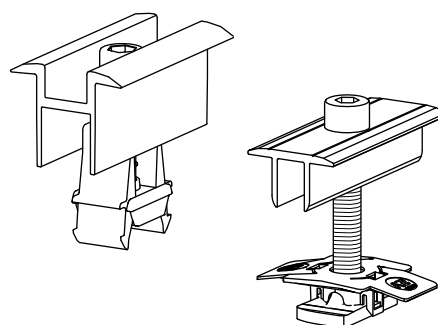

# Assembly

## Landscape

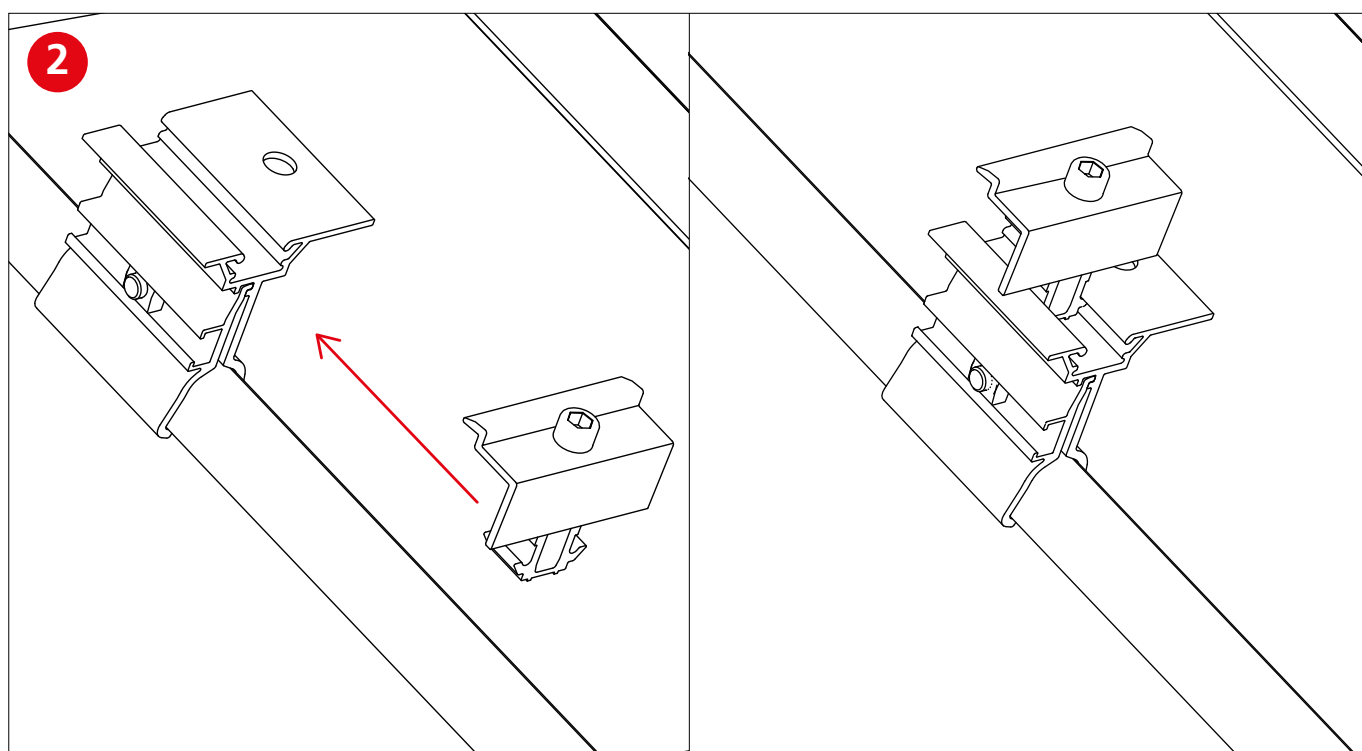
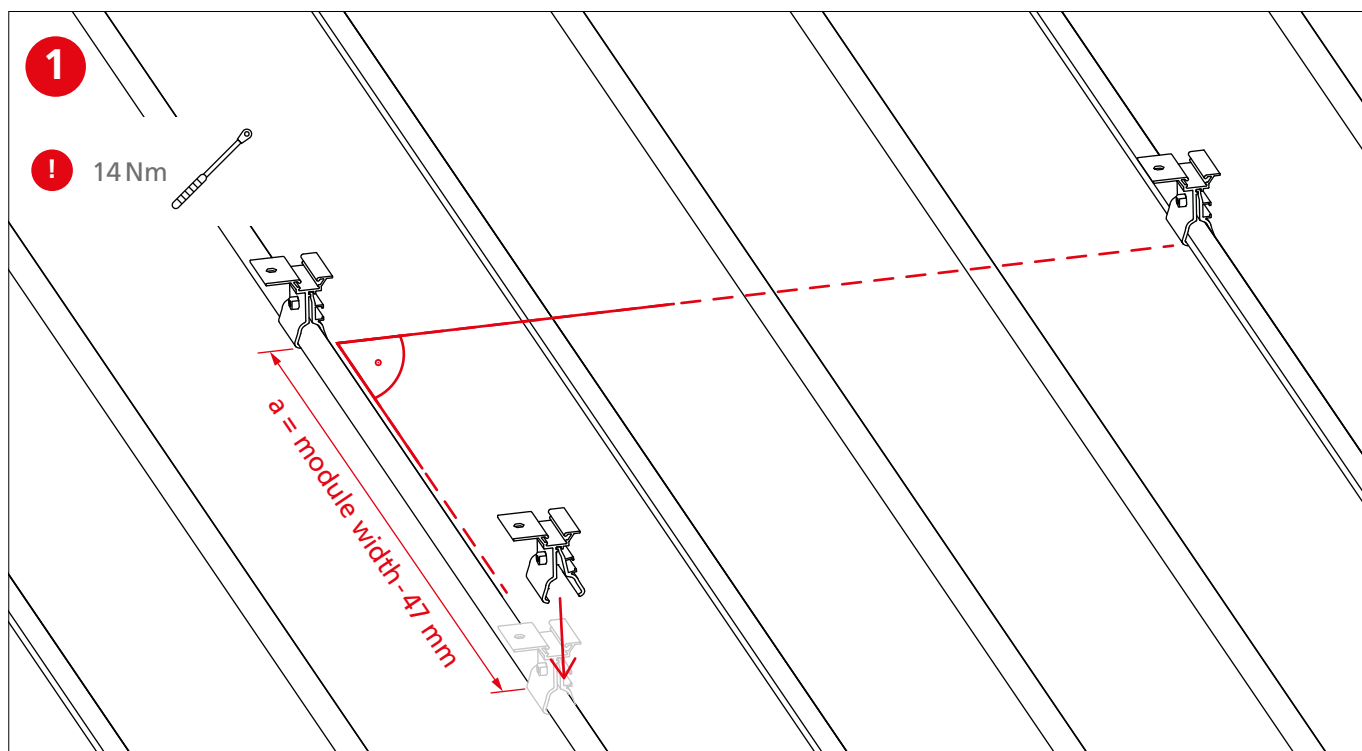



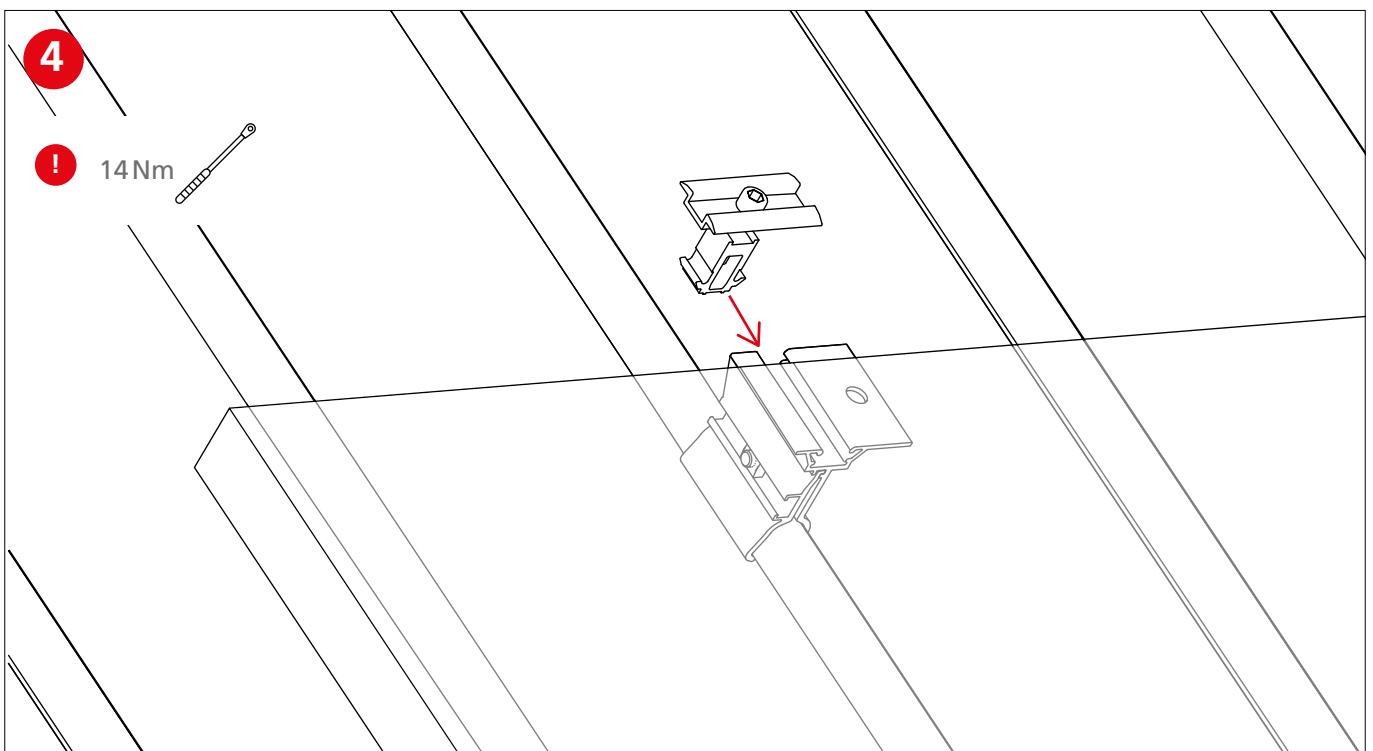
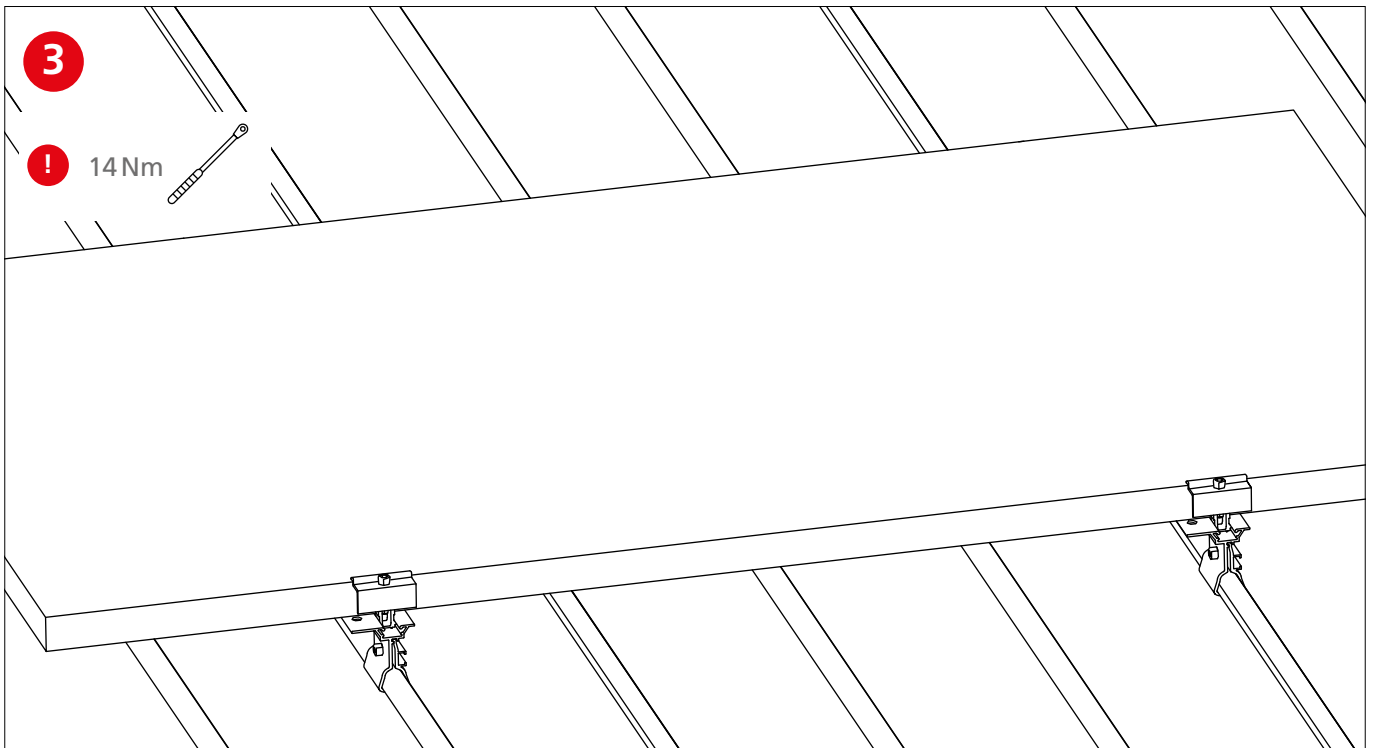

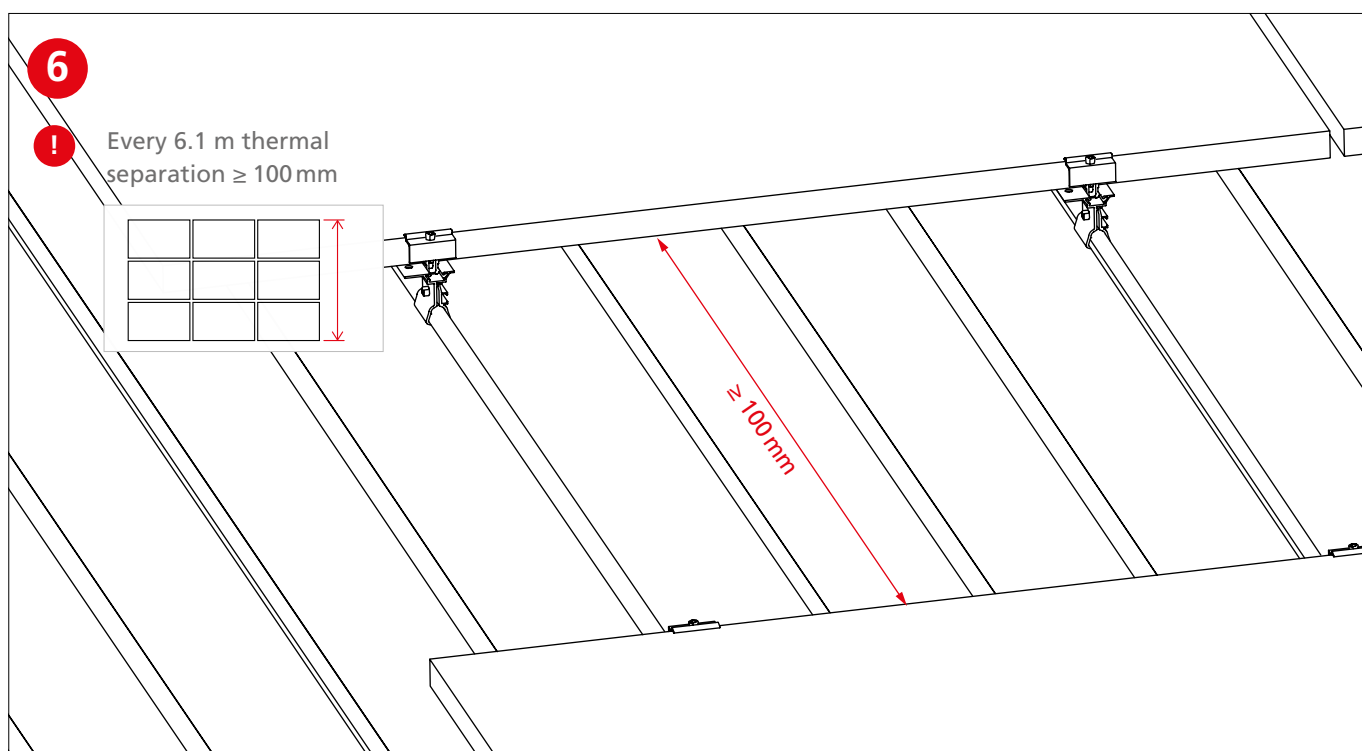
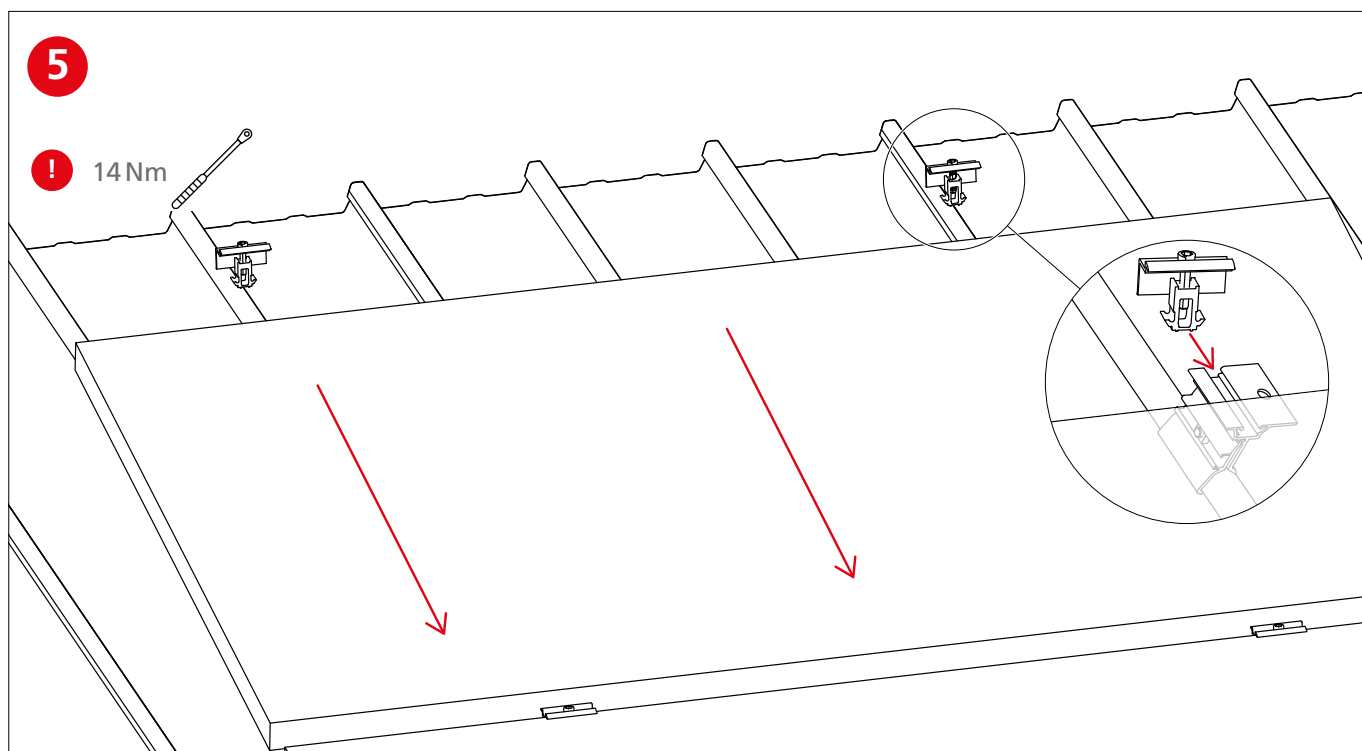

# Assembly



## Portrait

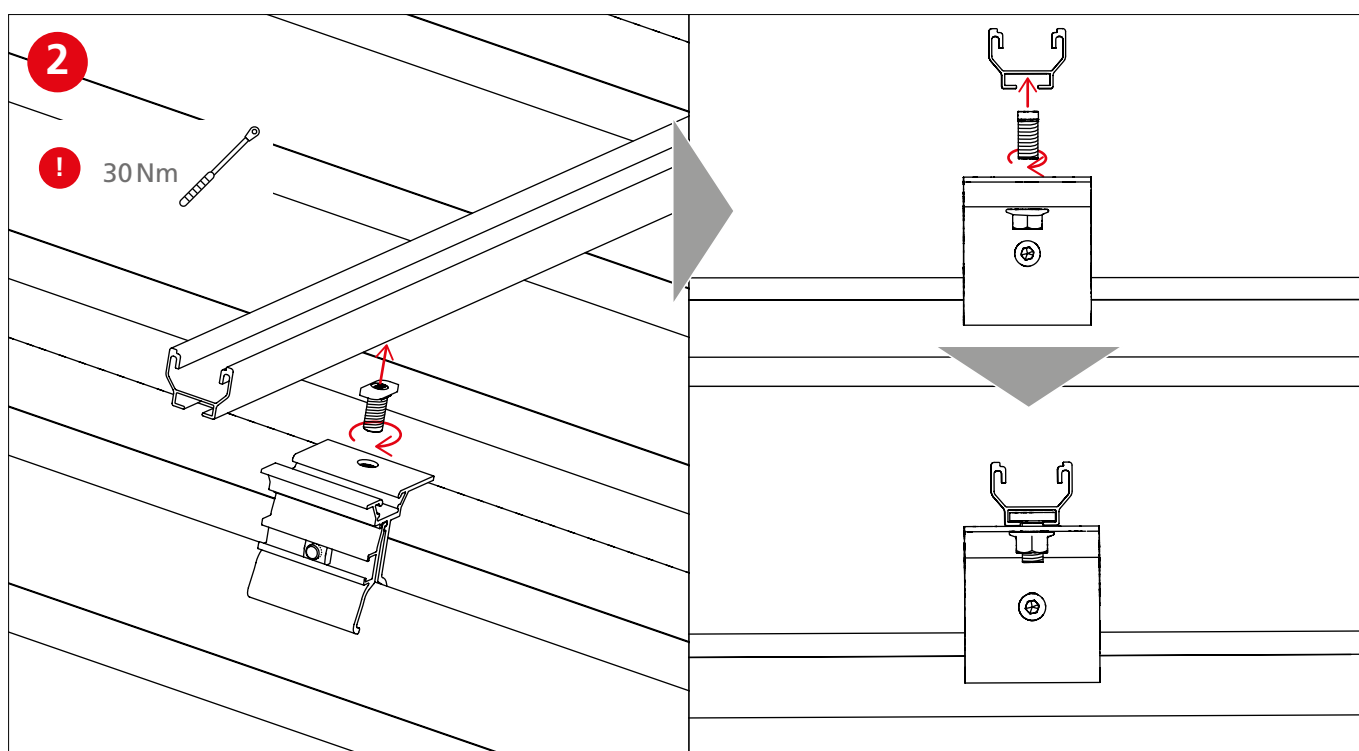
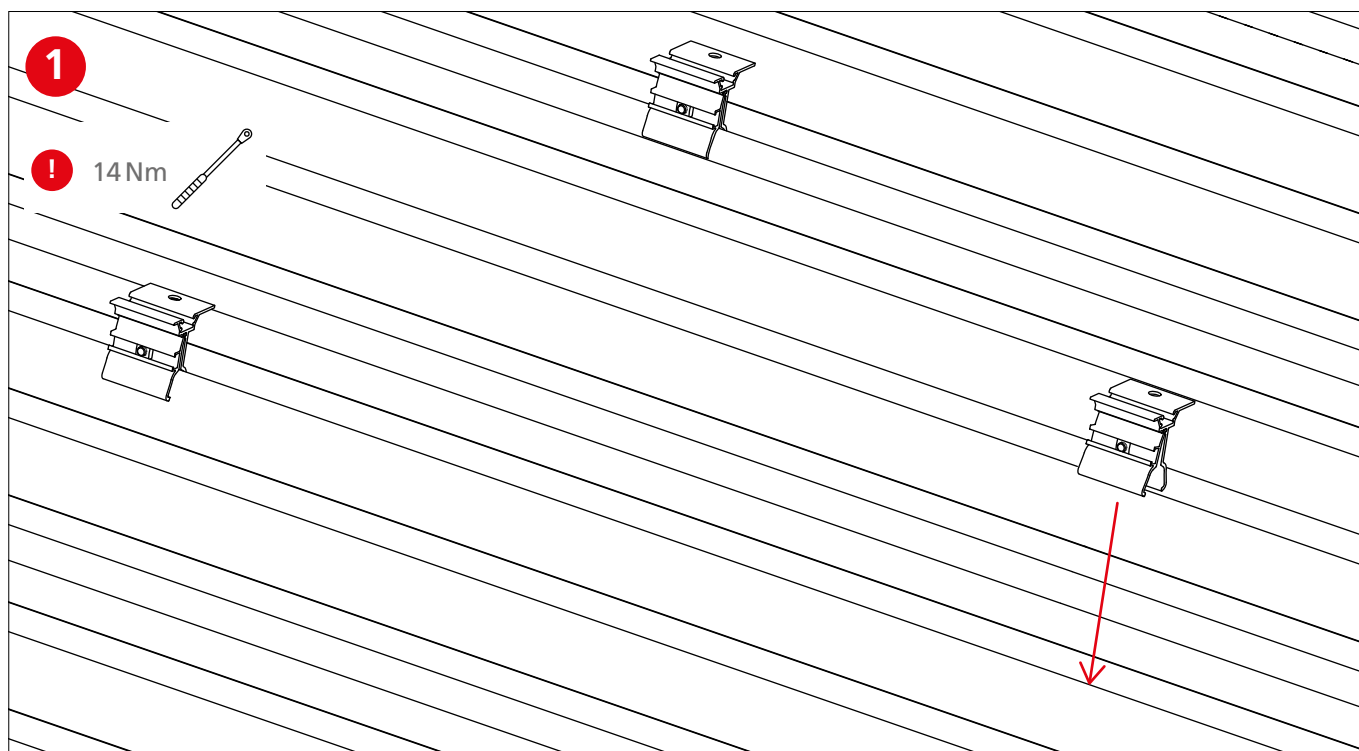

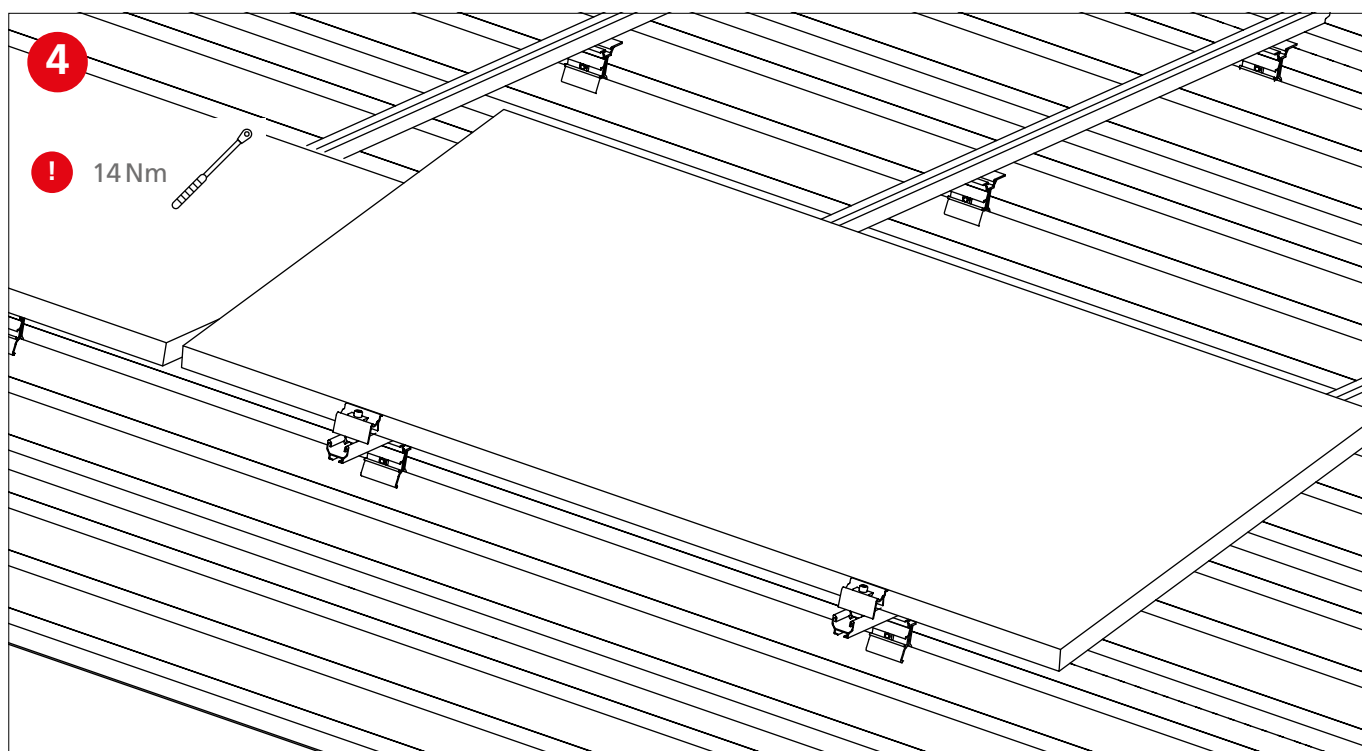
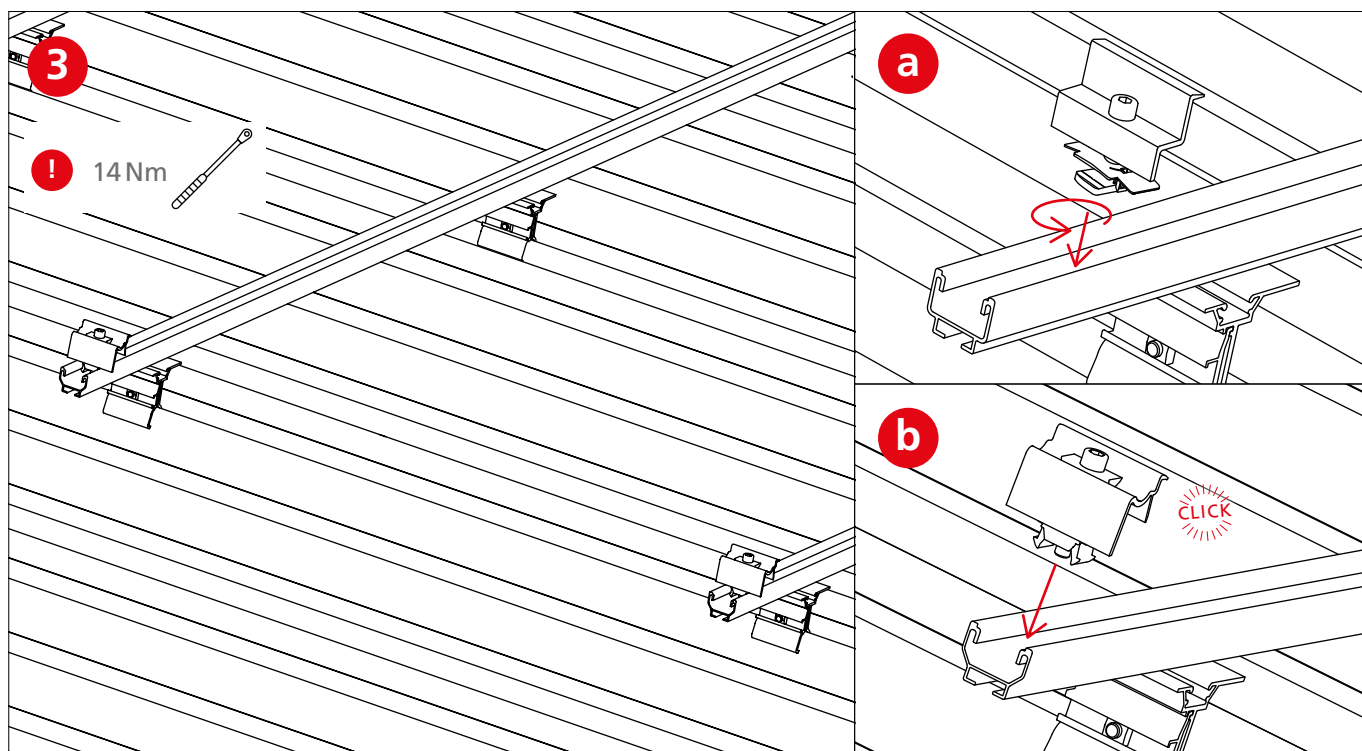

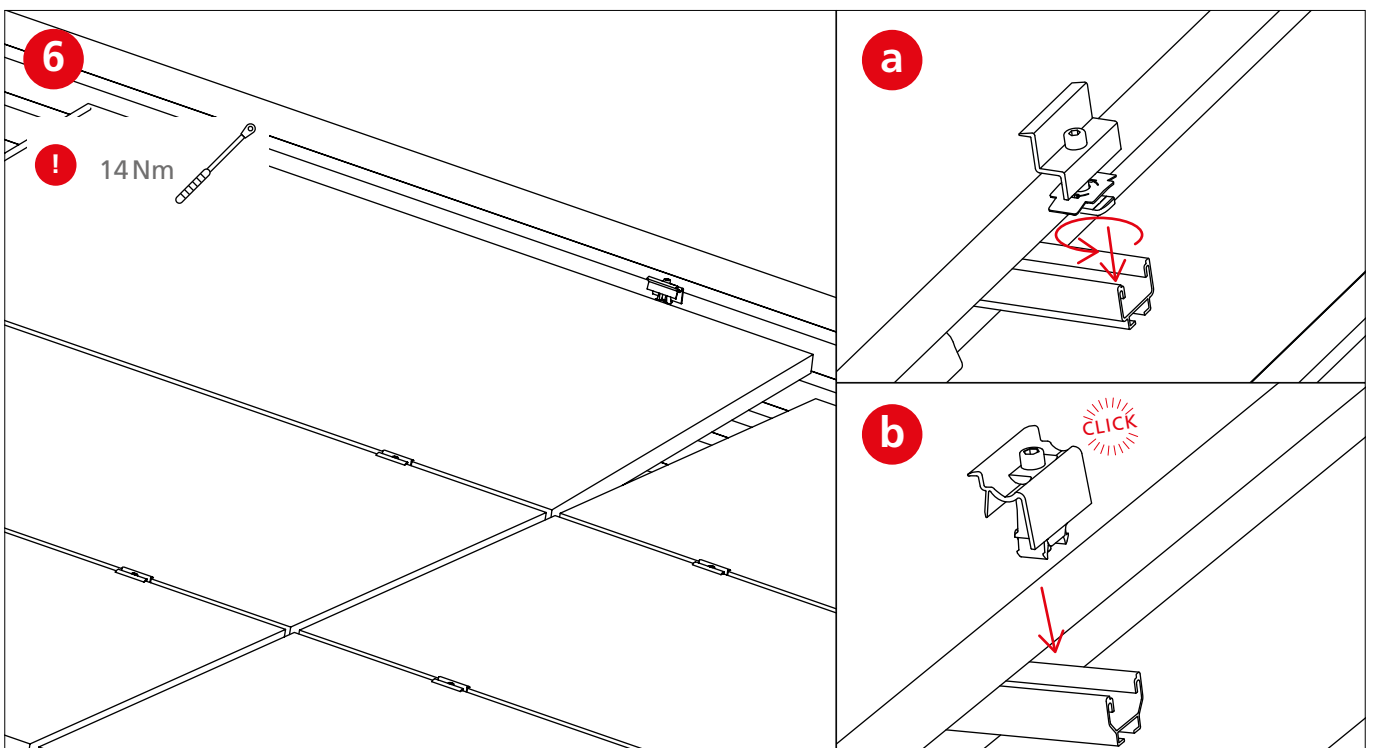
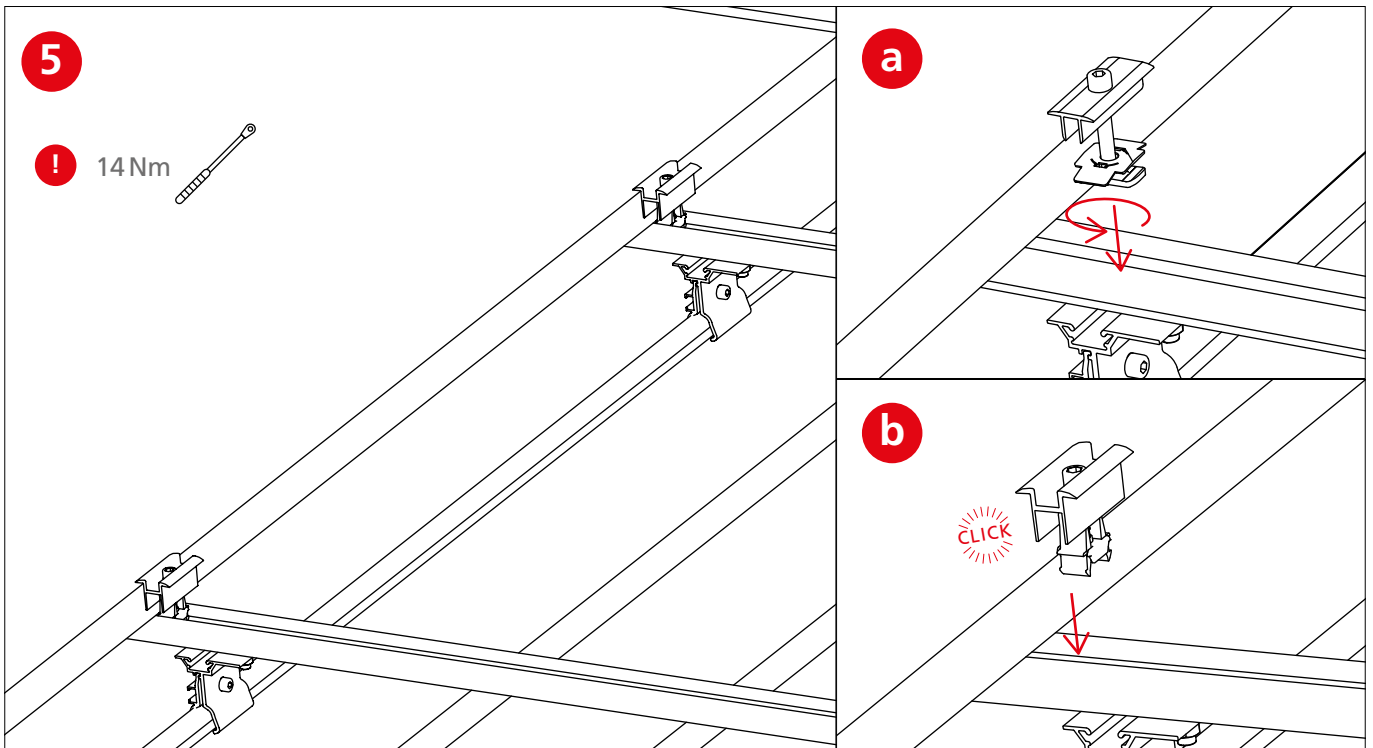

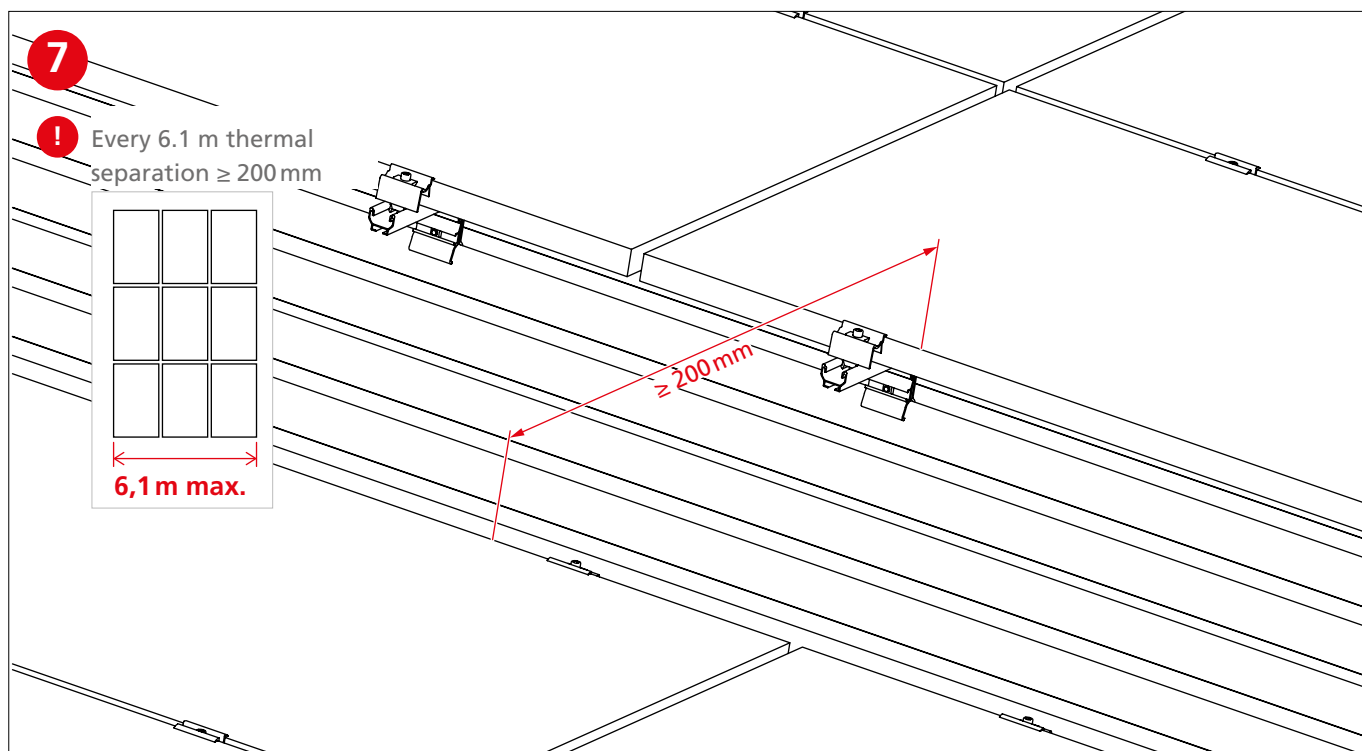



## Thank you for choosing a K2 mounting system.

Systems from K2 Systems are quick and easy to install. We hope these instructions have helped. Please contact us with any questions or suggestions for improvement.  
Our contact data:

- ▶ [www.k2-systems.com/en/contact](http://www.k2-systems.com/en/contact)
- ▶ **Service Hotline: +49 (0)7159 42059-0**

German law shall apply excluding the UN Convention on CISG.  
Place of venue is Stuttgart.

Our General Terms of Business apply. Please refer:  
[www.k2-systems.com](http://www.k2-systems.com)

**K2 Systems GmbH**  
Industriestraße 18  
71272 Renningen  
Germany  
Tel. +49 (0) 7159 - 42059 - 0  
[info@k2-systems.com](mailto:info@k2-systems.com)  
[www.k2-systems.com](http://www.k2-systems.com)